

# Installation Manual

SUZUKI SWIFT 5DR  
SUZ-SWFT-5-C



COMPONENTS INCLUDED

SHADES

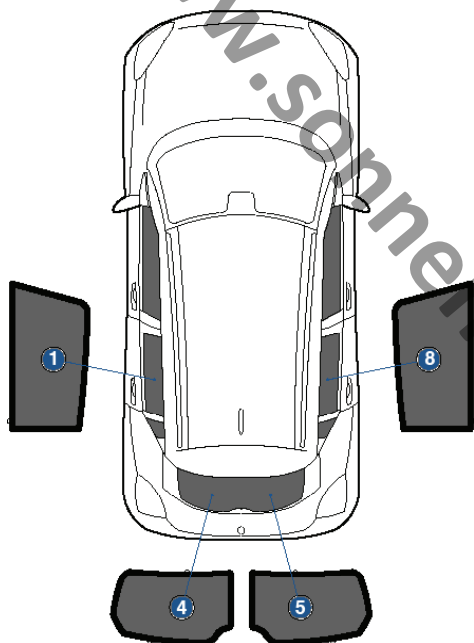

FIXING CLIPS

**CAR**  
SHADES



CL-M02 x 6



CL-M09 x 2



CL-M05 x 2



CL-M13 x 2



CL-M14 x 1



CL-T01 x 1

# Side Shade Installation

SUZUKI SWIFT 5DR  
SUZ-SWFT-5-C

## COMPONENTS NEEDED:



### STEP #1

INSERT CLIPS INSIDE WEATHERSTRIP



### STEP #2

POSITION THE SIDE SHADE

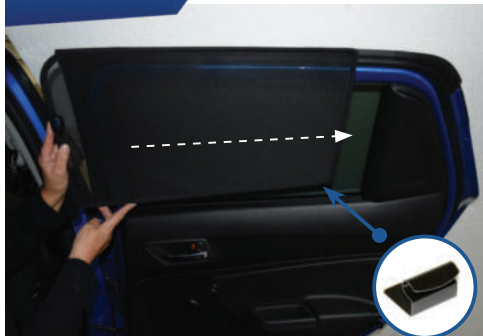

### STEP #3

ATTACH SIDE SHADE BEHIND CLIPS



### STEP #4

ENSURE SECURELY FITTED IN PLACE

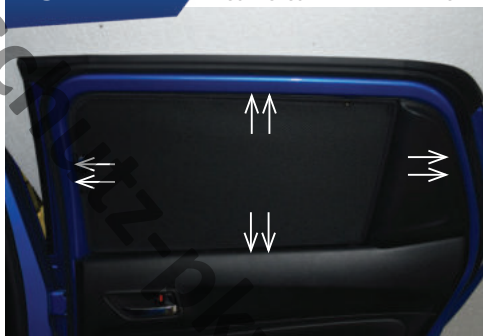

**CAR**  
SHADES

# Rear Shade Installation

SUZUKI SWIFT 5DR

SUZ-SWFT-5-C

COMPONENTS NEEDED:

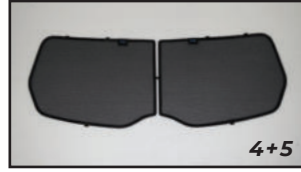

CL-M02 x 3



CL-M14 x 1

## STEP #1

ATTACH CLIPS ON SHADE EDGES



## STEP #2

POSITION THE REAR SHADE



## STEP #3

INSERT CLIPS BEHIND INTERIOR TRIM



## STEP #4

REPEAT THE PROCESS ON OTHER SHADE



## STEP #5

ENSURE SECURELY FITTED IN PLACE

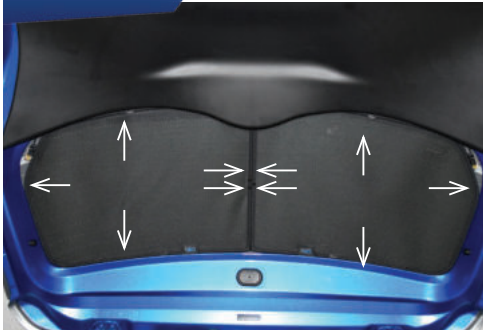

**CAR**  
SHADES